

# Architectural Door Accessories

# ASSA ABLOY

# Pemko DSG-FT-06 Designer Series

The global leader in  
door opening solutions

**WARNING: Must be installed into wall blocking.**

**If you have questions about what type of wall blocking is required, consult a structural engineer.**

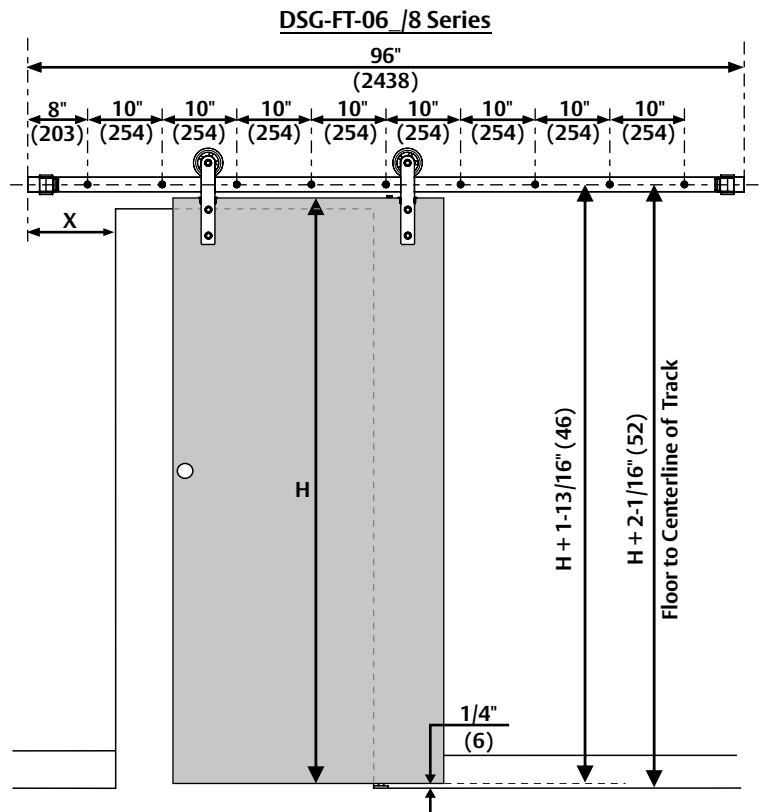
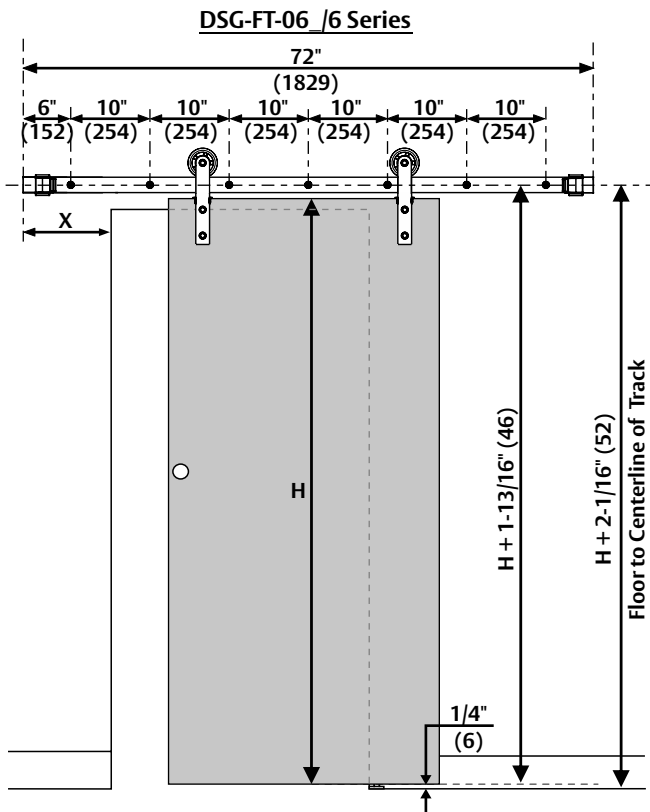

## Tools Required:

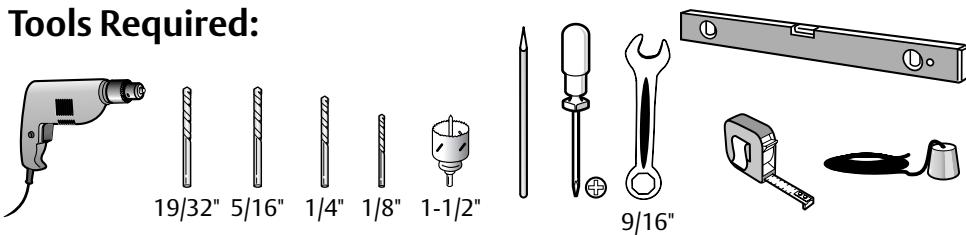

Dimensions shown: Inches (mm)

Notes:

1. "X" = Door Overlap
2. Minimum door overlap on guide side is 2" (51).
3. **Must be installed into wall blocking. If you have questions about what type of wall blocking is required, consult a structural engineer.**

### Parts:

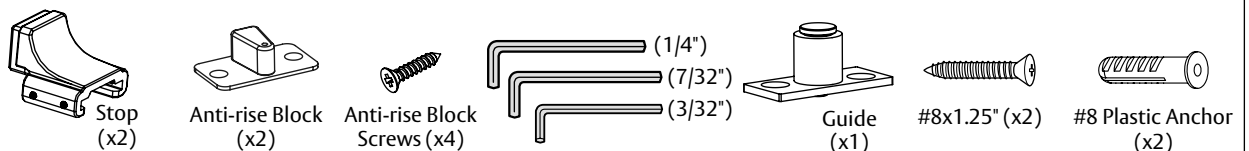
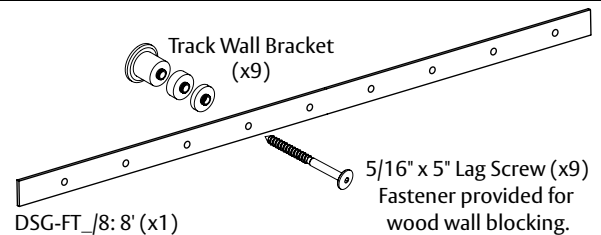
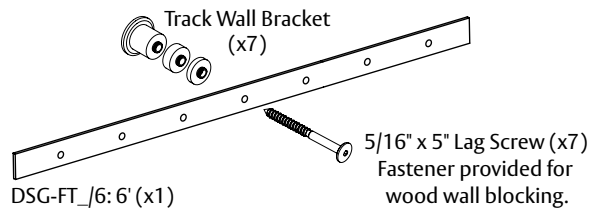
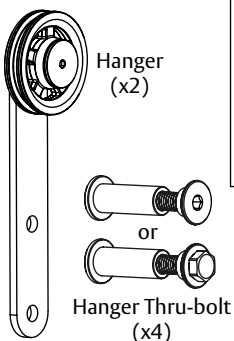

1. Prepare door for hangers.

Drill holes in door for hanger bolts using a 19/32" bit as shown.

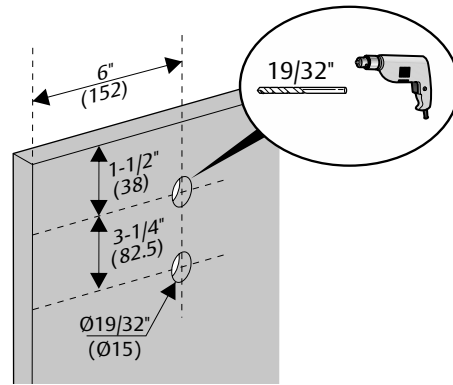

2. Install anti-rise block.

Pre-drill holes for fasteners with 1/8" bit. Install anti-rise block on wood door and rotate to position 1 as shown.

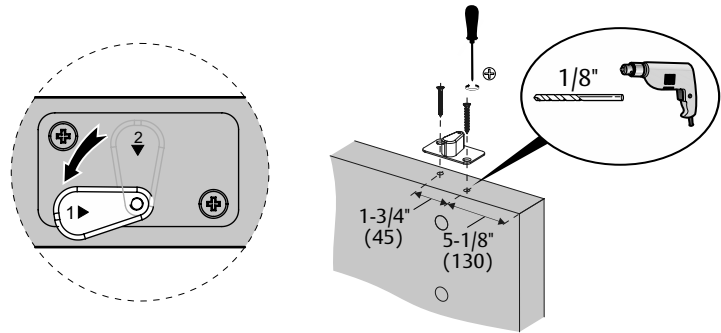

3. Mount hangers to door.

Mount hangers to door as shown.

Use hex head bolts with hanger finishes  
IS, WB, or BS.

Use flat cap bolts with hanger finishes SS or BZ.

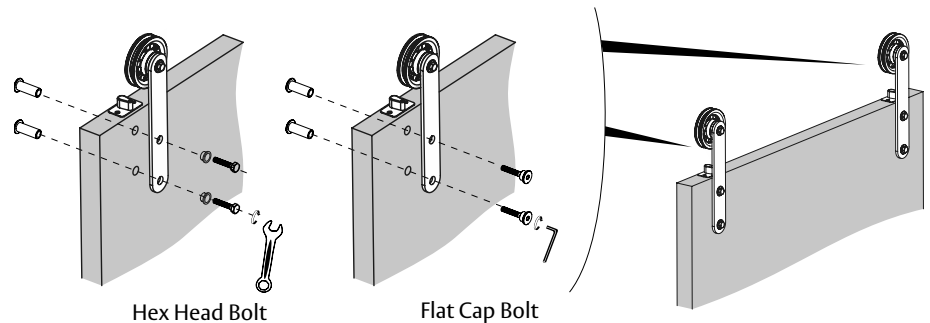

4. Mark for track.

At center of door's travel location (guide location), locate center line of track using formula on first page.

Using a level and track as a template, mark screw locations on wall as shown.

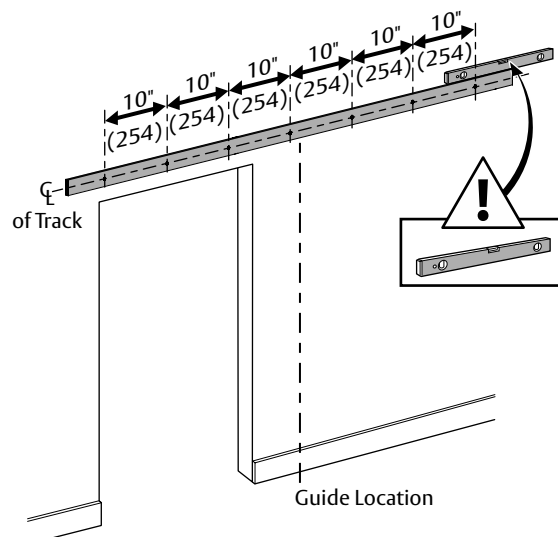

## 5. Choose wall brackets.

Choose proper amount of wall brackets / spacers per drawing as shown. Take note of door thickness, trim or other conditions that will require more clearance.

Wall Bracket Combination				
	A	A + C	A + B	A + B + C
"Y"	7/16" (11)	11/16" (17)	7/8" (22)	1-1/8" (28.5)

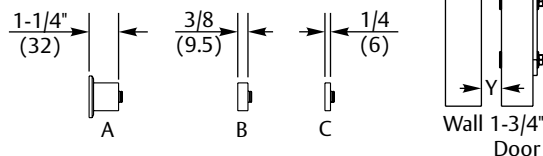

## 6. Secure track.

Drill 1/4" pilot holes in marked locations for track fasteners.

If applying track to gypsum board, use 1-1/2" hole saw to remove gypsum board at bracket locations. Use appropriate spacer kit, sold separately, to replace gypsum board removed by 1-1/2" hole saw.

Attach track to wall using track brackets and fasteners as shown.

Insert stops onto track ends.

Do not tighten stops at this time.

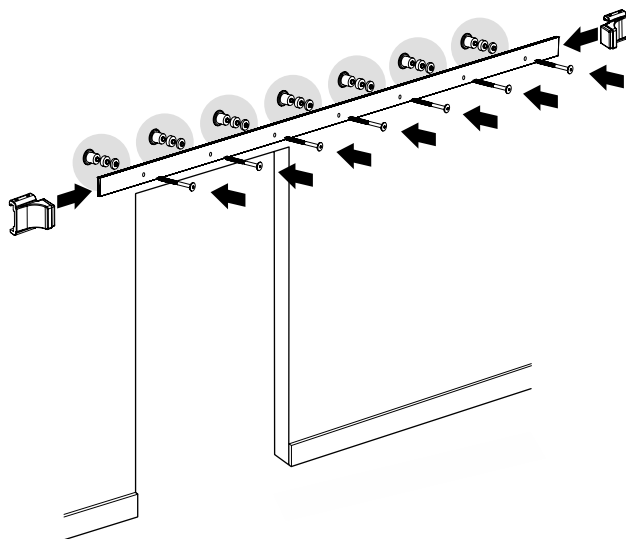

## 7. Route door.

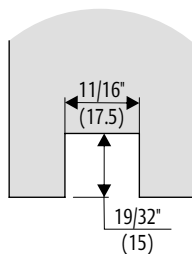

## 8. Fit door guide to floor.

Locate center line of guide based off of "Y" dimension in step 5.

Using door guide as a template, position and mark screw locations.

Drill pilot holes for anchors using 5/16" drill bit.

Mount guide to floor with anchors and #8 x 1.25" screws.

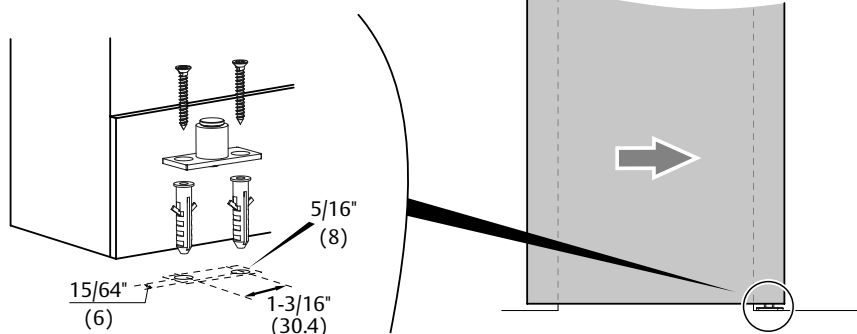

**ASSA ABLOY**

The global leader in  
door opening solutions

Copyright © 2017, Pemko Manufacturing Co., an ASSA ABLOY Group company. All rights reserved.  
Reproduction in whole or in part without the express written permission of Pemko Manufacturing Co. is prohibited.

81049 07/17

## 9. Hang door.

Lift door onto track.

Routed bottom of door will receive floor mounted guide.

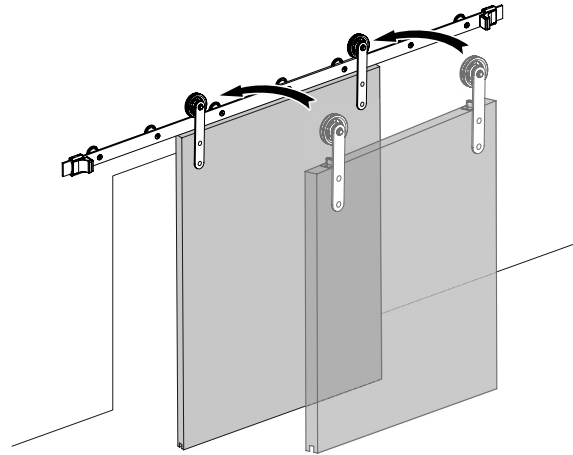

## 10. Rotate anti-rise block to position 2.

Rotate anti-rise block as shown.

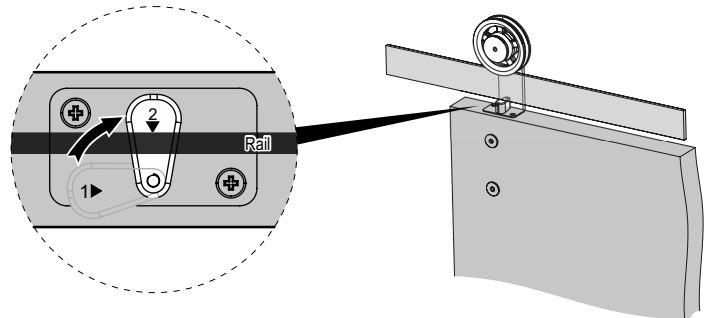

## 11. Adjust stops.

Adjust stops accordingly.

Tighten set screws. Start with bottom set screws then move to top set screws with sufficient force to drive set screws into bar after final adjustment.

